

# StoGuard® Waterproof Air Barrier Masonry Construction

## Rough Opening Protection with StoGuard® RapidSeal™

Date: April 2012

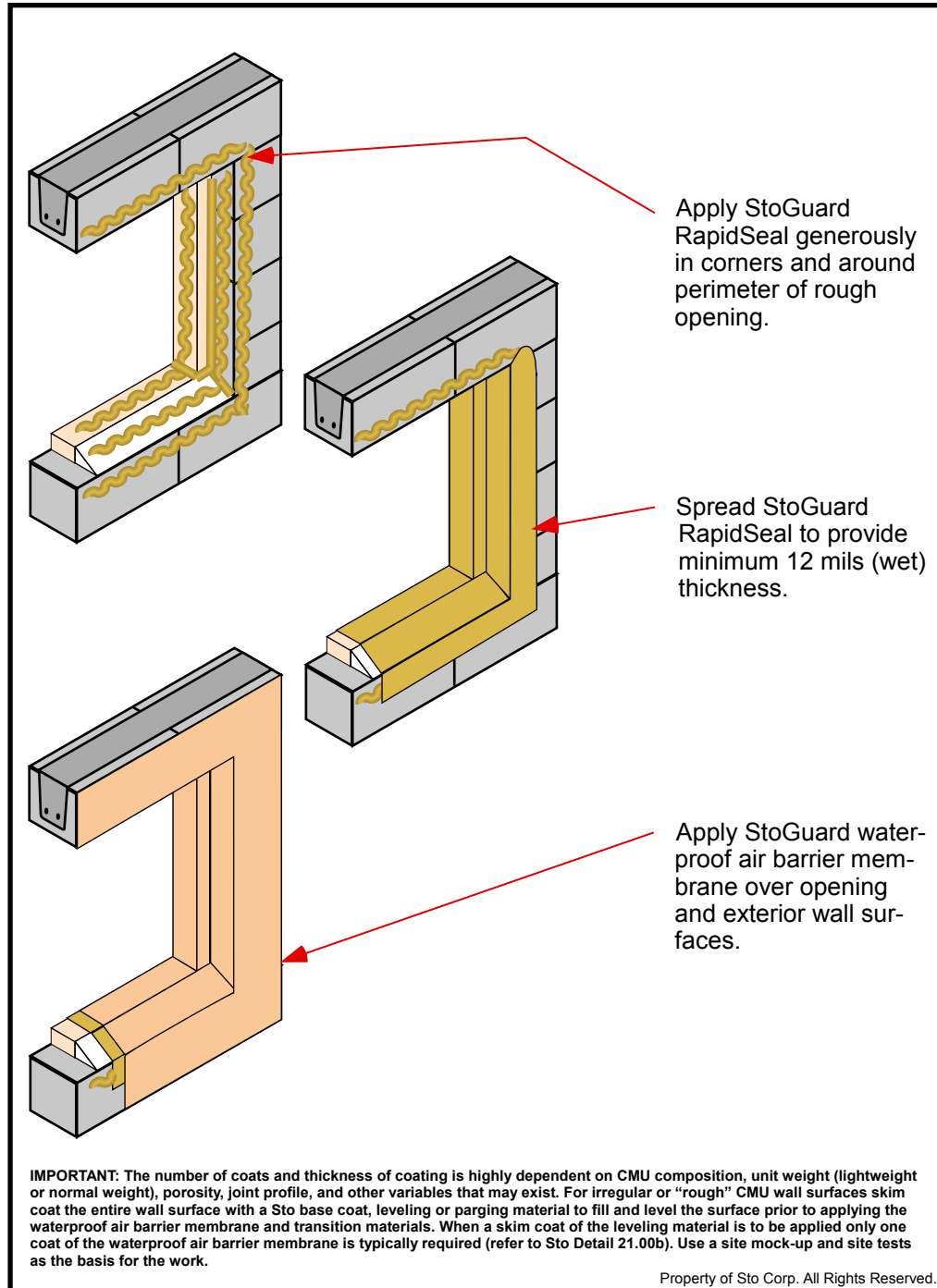

### Notes:

- 1] Prepare substrate in accordance with Sto Detail 21.00a, 21.00b or 21.00c.
- 2] Refer to Sto Details 21.00a, 21.00b and 21.00c for StoGuard waterproof air barrier membrane product options. All applications must be applied such that a void and pinhole free surface is achieved.
- 3] Incorporate flashing as illustrated in Sto Detail 21.23 or per other details where flashing is shown.
- 4] The complete installation of the window or mechanical equipment must include an air seal between the object and the StoGuard protection, inbound of the outer perimeter weather seal.
- 5] Refer to Sto specifications and product bulletins for detailed information on substrates and Sto material options.

**IMPORTANT:** Components not identified as Sto are furnished by other manufacturers and are not necessarily installed by trades who install the Sto products. Refer to project specific contract documents.

### Attention

Sto products are intended for use by qualified professional contractors, not consumers, as a component of a larger construction assembly as specified by a qualified design professional, general contractor or builder. They should be installed in accordance with those specifications and Sto's instructions. Sto Corp. disclaims all, and assumes no, liability for on-site inspections, for its products applied improperly, or by unqualified persons or entities, or as part of an improperly designed or constructed building, for the nonperformance of adjacent building components or assemblies, or for other construction activities beyond Sto's control. Improper use of Sto products or use as part of an improperly designed or constructed larger assembly or building may result in serious damage to Sto products, and to the structure of the building or its components. **STO CORP. DISCLAIMS ALL WARRANTIES EXPRESS OR IMPLIED EXCEPT FOR EXPLICIT LIMITED WRITTEN WARRANTIES ISSUED TO AND ACCEPTED BY BUILDING OWNERS IN ACCORDANCE WITH STO'S WARRANTY PROGRAMS WHICH ARE SUBJECT TO CHANGE FROM TIME TO TIME.** For the fullest, most current information on proper application, clean-up, mixing and other specifications and warranties, cautions and disclaimers, please refer to the Sto Corp. website, [www.stocorp.com](http://www.stocorp.com).

[www.stocorp.com](http://www.stocorp.com)